

Ultimate Aquarium DC-Pump

Professional DC Pump

3000 , 5500 , 8000 ,10000 , 15000 , 20000



User Manual

Thank you for purchasing the ZOOX Ultimate Aquarium DC Pump.
This product can be used as a circulation pump in both freshwater and seawater environments.
This manual supports DC3000, DC5500, DC8000, DC10000 ,DC15000, DC20000L.
Please read this instruction manual carefully and understand the usage and structure before use.
After reading, keep it in a place where you can read it again at any time.

Safety Guide

The precautions are for the safe and correct use of the product and to prevent harm or damage to the user or other people.
Attachment are the warning levels with different situations.
Please read carefully to have the best performance and safety.

Classification of Warning

 Danger	That is mean it has the possibility of serious injury to people or death immediately
 Warning	That is mean it may cause the serious injury to people or death if keep running in this situation
 Attention	That is mean it may cause property damage or even damage to people

Meaning of Marks

 FORBID	 FORCE	 UNPLUG THE POWER
--	--	---

HANDLING OF POWER PLUG, POWER CORD & SOCKET

WARNING

 The power supply is AC 100V, and the outlet with a rating of 15A or more need to be used alone.
Use of an AC outlet other than 100V or using an outlet with other equipment at the same time may cause a fire or electric shock.
If you need an extension cord, use the one with the correct rating. Using cords with amperage and wattage that are lower than the rating of the quipment may result in overheating.

 Do not forcibly bend, pull, twist, slap, or place heavy objects on, pinch, or modify the power cord or power adapter. The power cord may be damaged, resulting in fire or electric shock.

 Do not connect or disconnect the power with wet hands. It may cause an electric shock.

 Insert the power adapter securely to the bottom
Failure to do so may cause fire due to electric shock or overheating.

 Always have a drip loop on the power cord. Do not allow water droplets to travel through the cord and come in contact with the outlet since it may cause a fire or electric shock.

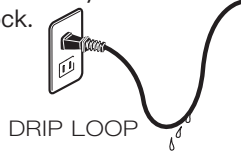

 Connect the ground wire securely
There is a risk of electric shock in the event of a failure or short circuit. Before connecting or disconnecting the ground, make sure that the power plug is disconnected from the

SAFETY GUIDE

HANDLING OF POWER PLUG, POWER CORD & SOCKET



WARNING



Unplug the power adapter when putting your hands in the aquarium or performing maintenance. It may cause electric shock.



Dust on power adapter needed to be cleaned regularly. Accumulated dust may cause fire due to moisture. Please wipe off with a dry cloth.



When pulling out the power adapter from the outlet, hold the power adapter first, then pull it out. If pulling out the cord while holding it, that may damage the cord and cause a fire or electric shock.

INSTALLATION



WARNING



Do not install in places with the high temperatures (e.g. near a fire, near a heater, under the scorching sun) or exposed directly under the sunlight. It can only be used indoors below 35 ° C.



Do not install in places where the power cord or ballast may get wet. It may cause electric shock and leakage.



ATTENTION



Be careful when carrying or installing this product in order to prevent damage from product.



Do not install this product near to children, since there is a danger to children.



Do not use or placed at outdoors. It may cause overheat, explosion, etc.

WHILE OPERATION



WARNING



In case of abnormality (burnt smell, etc), immediately unplug the power and stop using it. It may cause overheat or fire. Please contact the retailer that you purchased or our company.



Do not operate when the pump can not circulate water or the body is not filled with water. It may cause damage or fire.



Do not modify or process this product by yourself. It may cause damage or injury to people.



ATTENTION

Do not use for any purpose other than recommendation. It may cause an unexpected accident or danger.

●Before Use



Attention

- This product is for underwater use only.
- We do not compensate for living bodies by stopping the pump. Please use it after consent beforehand.

Please read the following precautions carefully before using the pump

- Be careful not to let the pump run idle due to a drop in water level.
- Be careful that do not let sand and foreign matter being sucked into the main unit.
This can cause serious damage. The warranty is not covered in this case.
- Do not use with corrosive or abrasive liquids.
- When holding the pump, do not lift the pump by the cord.
- Perform regular cleaning to prevent lime, algae, calcium and moss from adhering.
- Be sure to turn off the power before connecting the adapter connector to the controller.

●Specification

Model	Pump Max Power Consumption [※]	Rated voltage / frequency	Max Flow	Outlet hose inner diameter / PVC inner diameter	Body Size(cm)
DC3000	25W(±5%)	100-240V 50/60Hz	3000l/h	16mm/20mm	W16×D9.1×H18
DC5500	34W(±5%)	100-240V 50/60Hz	5500l/h	16mm/20mm	W18.5×D10.1×H19.3
DC8000	68W(±5%)	100-240V 50/60Hz	8000l/h	20mm/20mm	W18.5×D10.1×H19.3

※Does not include controller power consumption.

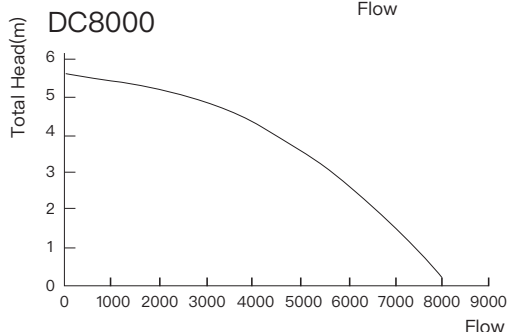
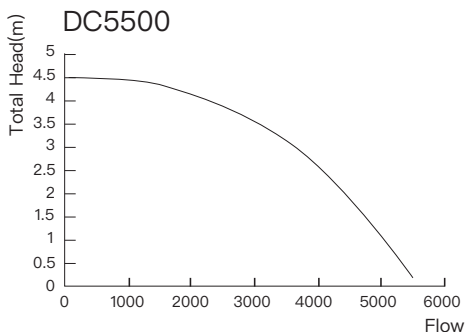
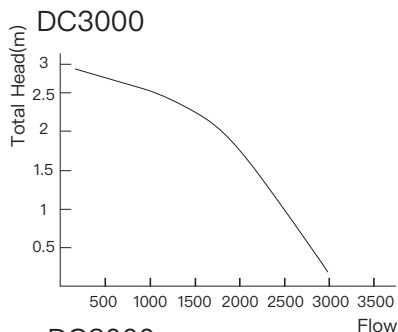

※The total head is the length of the pipe (hose) and varies depending on the pipe friction and the resistance when connecting equipment.

●Content

Remove the main unit and all attached parts from the box and check that if there any damage during transportation. In particular, make sure that the cord is not damaged. If any damage is found, do not use it and contact your dealer.

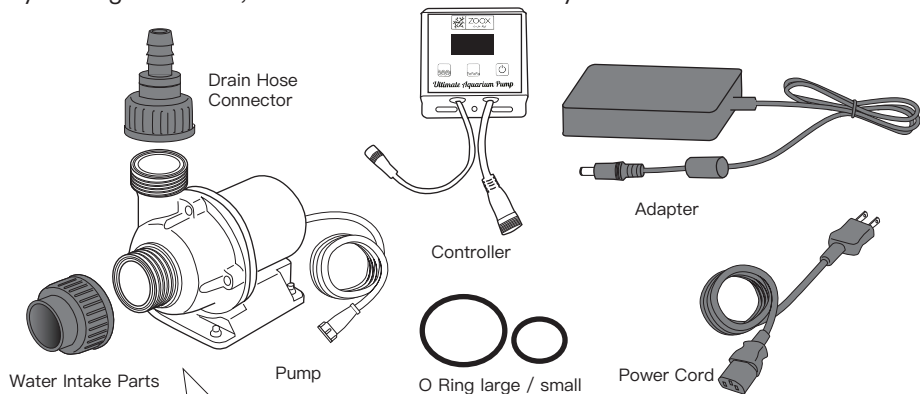

Name of each part

- A Pump Cover
- B Fixing Bolt
- C Fixing Nut
- D Impeller
- E O Ring
- F Pump Core
- G Pump Mount

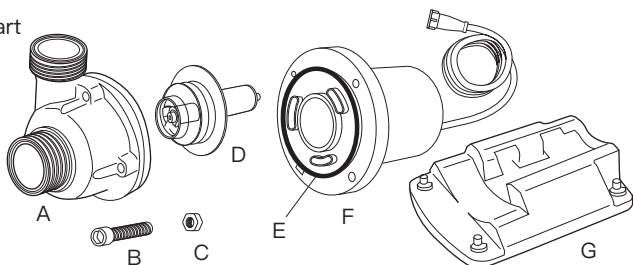

●Installation method in the water tank



Attention

Make sure that the pump does not run idle due to a drop in the water level at the pump installation location or water absorption location. Since it may cause a pump failure or serious accident. The warranty is not cover in this case.

Install the adapter and controller in a place without heat or humidity.

1. Attach the large O-ring to the water inlet and the small O-ring to the drain, and then attach the water inlet part and drain hose connector from above.

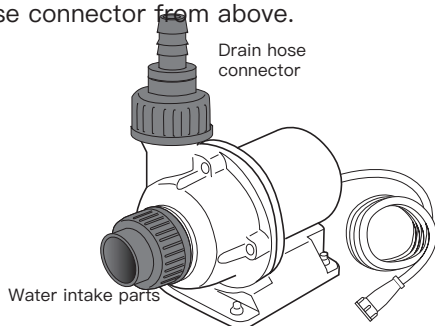
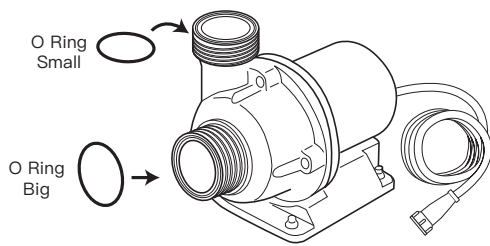

2. Connect the joint between the pump and controller referring to the following connection method.

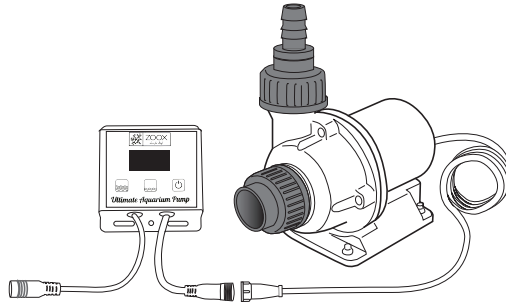

How to Connect

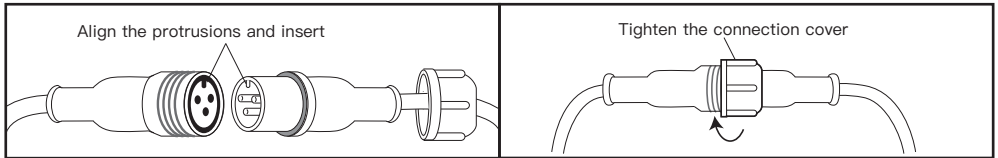

3. Connect the adapter to the controller.
4. Connect the power cord to the adapter.
※Before connecting, make sure that the power is not connected to the outlet.

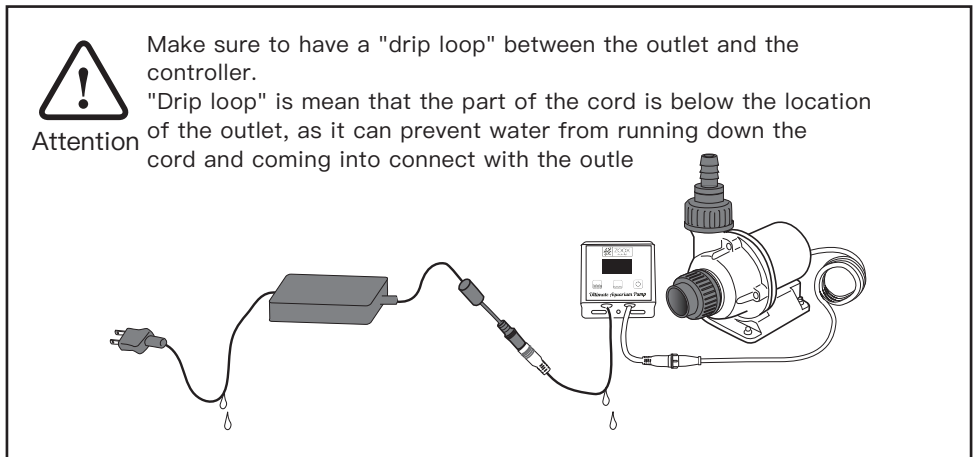

5. Make sure that the main unit is underwater and that the inside of the main unit is filled with water before connecting the plug to the outlet.

Precautions for Piping

Excessive drainage resistance results in reduced flow, abnormal pump noise and malfunction. Please observe the following precautions.

- Do not use a right-angle elbow pipe at the end of the water intake pipe or the drainage pipe. If necessary, use a pipe with a smooth angle.

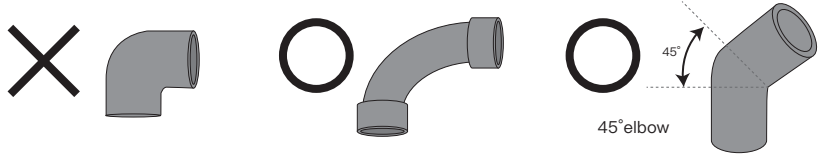

- Do not reduce the diameter in the middle of piping.

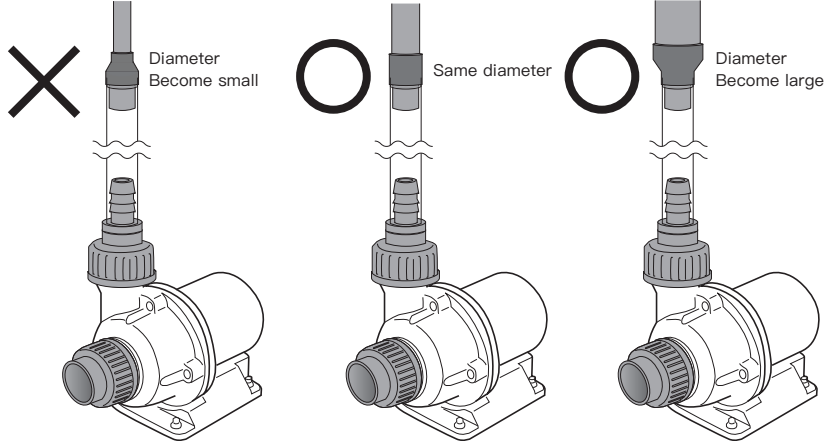

- When connecting a valve in the middle of piping, be sure to provide a bypass point.

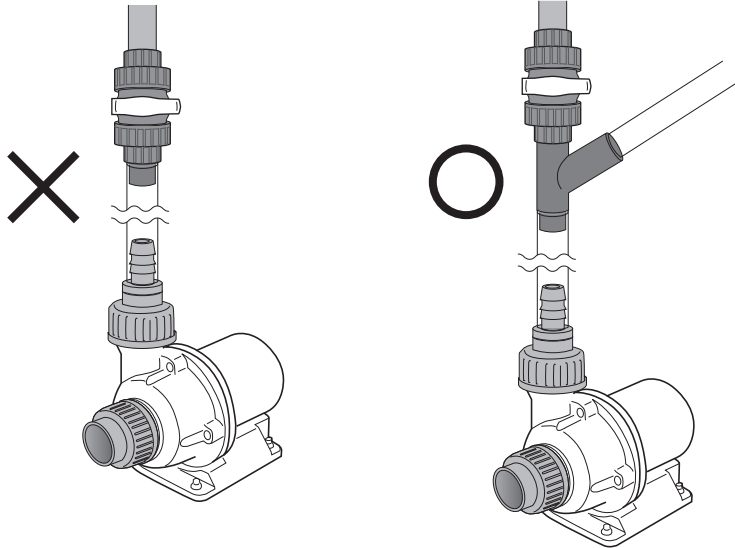

●How to use the controller

※Each button is a touch panel type, so do not push it strongly, as it will be the cause of the failure.

※The number (RPM) displayed in the center indicates the rotation speed of the impeller. Increasing the flow rate by increases the RPM (rotational speed), as well as decreasing it. In addition, when resistance is applied to the drainage, the RPM (rotational speed) increases to maintain the set flow rate.



Attention

It is recommended to use at a rotation speed (RPM) of 2500 rpm or less.

Use at high speeds not only increases power consumption, but also causes failures and accelerates wear.

If the flow rate is weak when used at 2500 rpm or less, check the connected devices and piping.

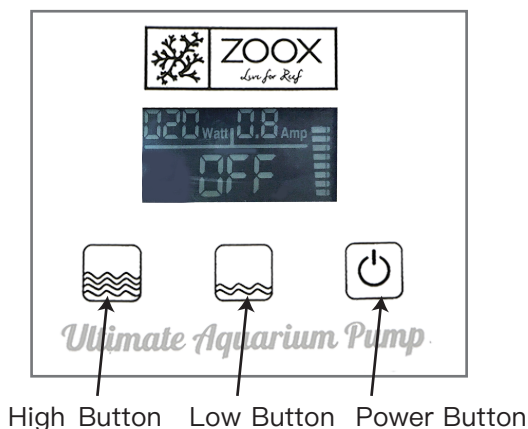

1. If you touch the High button while "OFF" is displayed, the pump will Starts running.
2. Use the "High button" and "Low button" to adjust the flow rate to match the tank. Touch the High button to increase the number of rotations to increase the water flow.
3. Touch the power button once to enter pause mode and stop the pump.
※Pause mode is released after about 30 minutes, and starts running with the power before the pause.
4. If you touch the power button again in the pause mode, the power turns off.

●Maintenance

For safety use, please do the maintenance (cleaning) to remove dirt and calcium components regularly (at least once a month). Also, remove dust and dirt from the power cord connection and the outlet.

- ※Be sure to disconnect the power plug from the outlet and make sure that the power is not turned on before doing the maintenance.
- * Please understand the structure of the pump well before proceeding.
- * Do not use detergent, hard sponge or brush.
- * When cleaning the power cord and outlet, clean with a dry soft cloth.

1. Use a hexagon wrench (not included, so please prepare separately)
Remove the fixing bolt (B). At this time, be careful not to lose the fixing nut (C).

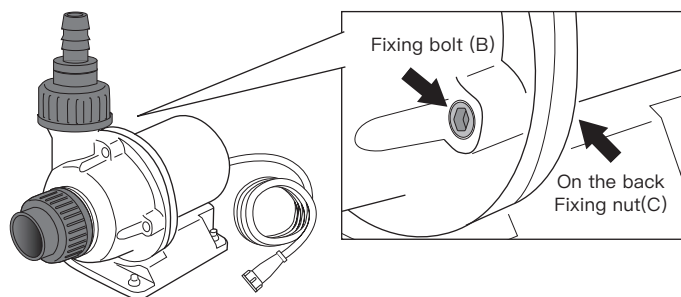

2. Remove the pump cover (A) from the pump core (F).
3. Remove the impeller (D) from the pump core (F).

Name of each part

- A Pump Cover
- B Fixing Bolt
- C Fixing Nut
- D Impeller
- E O Ring
- F Pump Core
- G Pump Mount

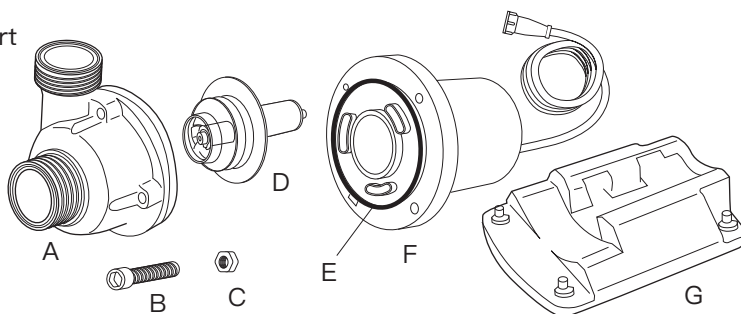

4. Use a soft-bristle toothbrush to remove any dirt from each part.
※If lime algae or calcium components are stuck, remove them using a special cleaner or Hydrochloric Acid.
5. Check the impeller if there any damage.
6. Check the O-ring if there any damage.
※Even small scratches can cause water leaks and malfunctions, so if you find them, replace them immediately.
* Impellers and O-rings are treated as consumables and are not covered by the warranty.
* We recommend that you apply silicone grease (sold separately).
7. Reassemble the pump in the reverse order of steps 1–3, and install it in the original place.
8. Turn on the power and check for any abnormalities for a while.

●Error Code Solution

Error Code	Cause	Solution
Er01	Run idle	Check that the water level at the pump location is not low. Add water if necessary.
Er02	Low voltage	Check that if it is connected to the genuine dedicated adapter. If used with heaters, coolers, lighting fixtures, and octopus wiring, the voltage may be constant. Review the wiring of the peripheral equipment. If the problem still exists, contact your dealer or us.
Er03	High voltage	Check that if it is connected to the genuine dedicated adapter. If the problem still exists, contact your dealer or us.
Er04	Water supply/ drainage pressure Abnormal	Check that there is no resistance to water absorption or drainage. If necessary, review the piping according to “Precautions of Piping” on page 4.
	Foreign matter contamination ・Dirt	Disassemble it and clean the pump.
Er05	Abnormal current	Check that if it is connected to the genuine dedicated adapter. If the problem still exists, contact your dealer or us.
	Foreign matter contamination ・Dirt	Disassemble it and clean the impeller and pump.

※All error codes cause the pump to stop automatically. After solving the problem, restart the pump.



Attention

Please note that we do not compensate for living bodies by stopping the pump

●Q&A

Q.The pump does not run even if the power is turned on and settings are made and saved.

A. The shaft of the impeller may be shifted due to transportation.

Take out the impeller once, check for any damage, and then reassemble.

* If the impeller is damaged, stop using it and contact your dealer or us.

Please contact us by email.

Email :info@zooxaquarium.com

ZOOX AQUARIUM LTD.

Email: info@zooxaquarium.com

Web:<http://www.zooxaquarium.com>